

For Polaris Dealer and Distributor Service Departments

February 27, 2001

S-01-03

Dealership Routing: Mgr./Owner - Svc. Mgr. - Svc. Tech - Svc. Tech - Parts Mgr. - Wty. Mgr. -

Subject

Recoil Housing Nut

Models Affected

Model Number

VIN Range of Affected Vehicles:

2001 500 Indy

S01NB4BS

All

2001 500 Classic

S01SD4BS

All

2001 500 Classic Touring

S01ST4BS

All

2001 Euro Wide Trak LX

E01SU4BU

All

2001 Wide Trak LX

S01SU4BS

All

Purpose

The recoil nut may come loose inside recoil assembly. Remove recoil housing and the retaining nut that holds recoil rope assembly, apply Loctite[®] 242 or 3-Bond 1342 to nut and re-torque to 49 in. lbs. (5.6 Nm). Reinstall recoil housing and torque cover bolts to 17-18 ft lbs (23-24.4 Nm).

Customer Notification

Please perform this Service Bulletin on all affected units in your inventory. Contact owners of delivered units immediately and make arrangements to perform this warranty repair.

Warranty Claim Preparation

A single group claim may be submitted listing the serial number and date of repair for all machines with the same model number. DO NOT PUT MORE THAN ONE MODEL NUMBER ON A CLAIM.

Warranty Information

:15 hours for each machine serviced. Use fail code **6727** during claim preparation. File claim type **SB (Service Bulletin)** for all affected models.

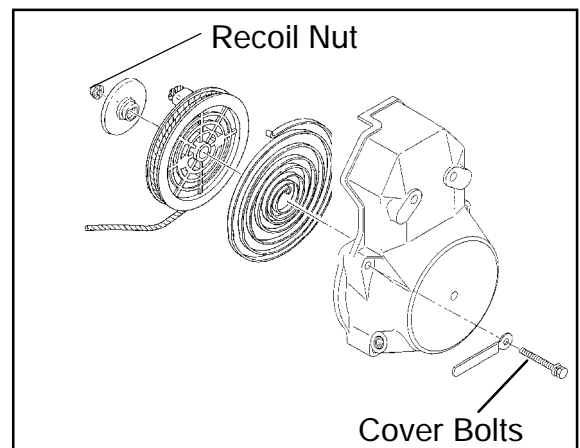

Sincerely,

POLARIS SALES INC.

A handwritten signature in cursive script that reads 'Craig M. Wilfahrt'.

Craig M. Wilfahrt
Manager, Service/Technical Training